

RS2875.203 LEADS

TORQUE STRENGTH RATING-5,500 FT-LB
 ULTIMATE COMPRESSION STRENGTH-60 KIP

=NOTES=

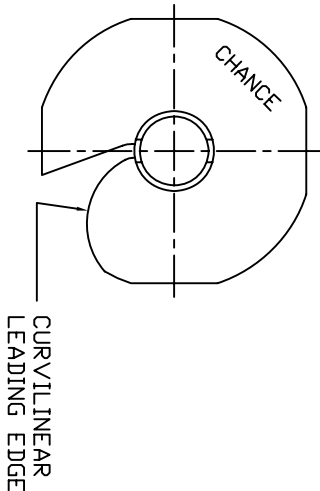

1. HOT DIP GALVANIZED PER ASTM A153-(LATEST REVISION)
2. LEAD EFFECTIVE AND PILOT POINT LENGTHS ARE NOMINAL.
3. PIPE SHAFT MATERIAL 2.5" NOMINAL, SCHEDULE 40 WALL THICKNESS PER ASTM A500 GRADE B.
4. DRIVE PLATE SCREWS PIPE SHAFT DOWN TO ROCK
5. MANUFACTURER TO HAVE IN EFFECT INDUSTRY RECOGNIZED WRITTEN QUALITY CONTROL FOR ALL MATERIALS AND MANUFACTURING PROCESSES.
6. ALL WELDING TO BE DONE BY WELDERS CERTIFIED UNDER SECTION 5 OF THE AWS CODE D1.1.
7. FOR ADDITIONAL PIPE SHAFT LENGTH, REFER TO DRAWING SA278-4500 LIFT PILE EXTENSIONS.

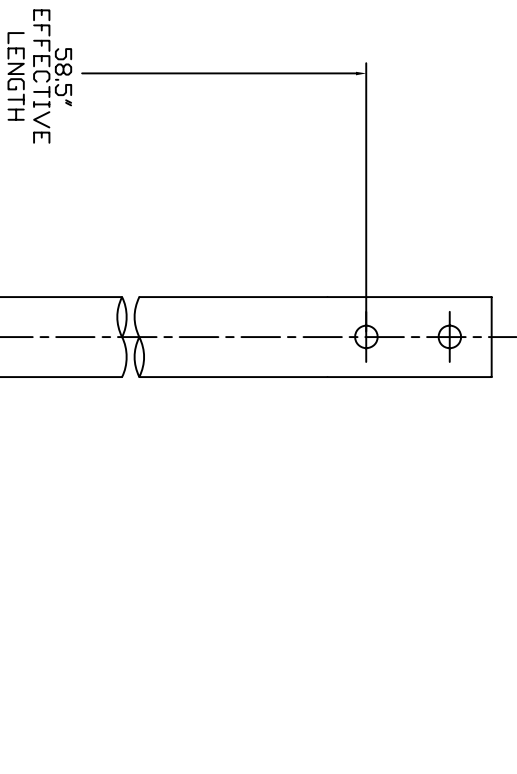

CATALOG NUMBER	DESCRIPTION
C278-4510	RS2875.203 LEAD, 58.5'
C278-4510NG	RS2875.203 LEAD, 58.5', NON-GALV

2-7/8" O.D. SCH. 40
 (<203" WALL)

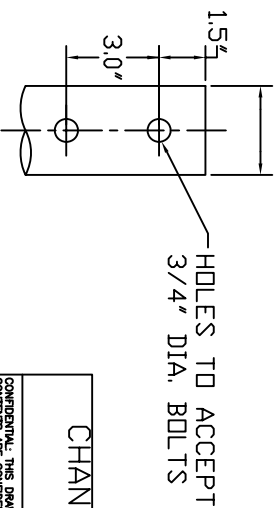

COUPLING BOLT
 HOLE DETAIL

CHANGE			
CONFIDENTIAL - THIS DRAWING AND ITS CONTENTS ARE CONFIDENTIAL AND THE EXCLUSIVE PROPERTY OF HUBBELL. DISTRIBUTION OR COPIES MAY BE MADE WITHOUT THE WRITTEN CONSENT OF HUBBELL. POWER SYSTEMS UNPUBLISHED. ALL RIGHTS RESERVED UNDER THE COPYRIGHT LAWS.		TITLE RS2875.203 PILE, LEAD	
SIZE SC SA278-4510 DO NOT SCALE THIS DRAWING	DWG NO. SA278-4510	DWT / PART / ASST NO. SEE CHART	REV B
HUBBELL POWER SYSTEMS		DWN BY KSH	DATE 2/14/05 SHEET 1/1